

BALL VALVE - 2 WAY - High Pressure Up to 500 bar

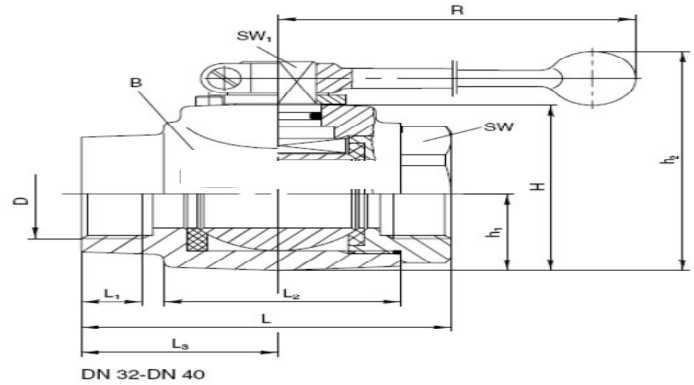

BSPP Female Threads Both End As per DIN 3230 T 5 and ISO 5208

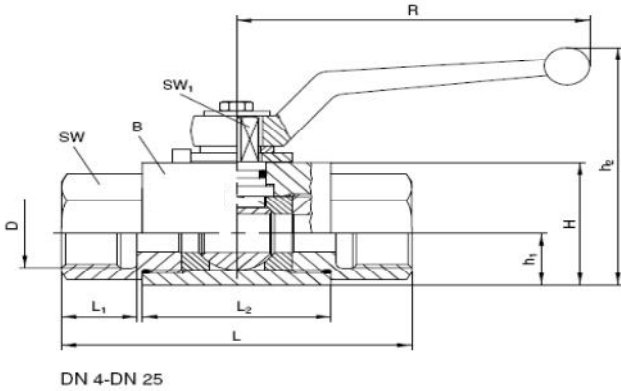

Thread	VE-LOCK	DN	PN	L1	L2	L	B	H	h1	h2	SW1	SW	R	Weight
D	Part Code		( Bar )											gr/1 Piece
G 1/8"	VE BV 012	4	500	15	38	68	20	34	10	55	7	19	76	220
G 1/4"	VE BV 013	6	500	15	38	68	20	34	10	55	7	19	76	210
G 3/8"	VE BV 014	10	500	15.25	42	72.5	27	40	14.5	68	8	24	100	430
G 1/2"	VE BV 015	12	500	18.5	48	85	30	41	17	92	10	27	112	670
G 5/8"	VE BV 016	16	400	19	50	88	40	45	20	105	11	36	166	973
G 3/4"	VE BV 017	20	315	17	60	93.5	45	55	24	113	14	41	187	1280
G 1"	VE BV 018	25	315	25	63.7	117.2	55	63	26	118	14	50	187	1982
G 1 1/4"	VE BV 019	32	315	27.3	64	116.5	73	66	36.5	104.5	17	60	240	2450
G 1 1/4"	VE BV 020	25	315	27.3	64	116.5	55	66	26	118	14	55	187	2050
G 1 1/2"	VE BV 021	40	315	30.75	63	124.5	85	63	42.5	114.5	17	70	240	3401
G 1 1/2"	VE BV 022	25	315	30.75	63	124.5	55	63	26	118	14	55	187	2200

\* The above threads are shown BSPP ( Female x Female )

**Materials :-**

VALVE BODY - STEEL - ZINC PASSIVATED  
 VALVE BALL - SS 304  
 SEALING - BALL SEAT WITH POM (DELTRIN)  
 SEALING - WITH O RING -NBR  
 Handle - made out of Zinc Casting  
 All other Parts are trivalent White Plating

**Application of This Ball Valve-**

Suitable for Petroleum based fluid / Oil / Lubricants  
 for Air Application suitable up to 100 Bar Working Pressure

**TEMP RANGE : -10 UP TO + 80 DEGREE C**