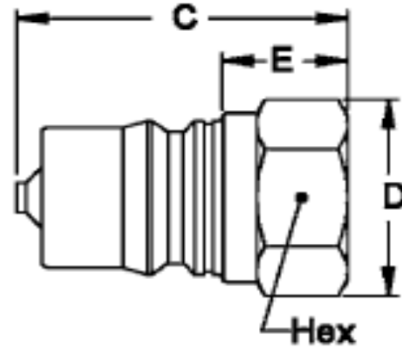
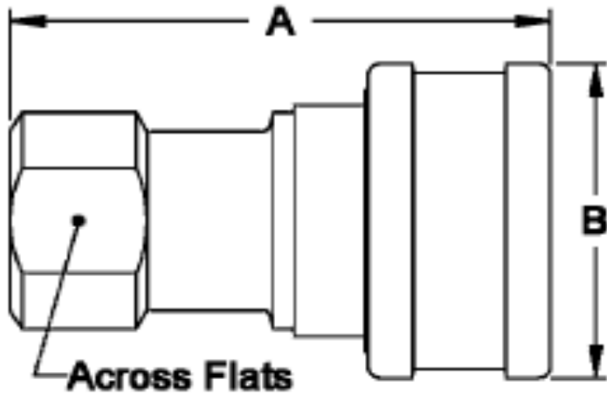

QUICK RELEASE COUPLING

AS PER VE-LOCK TYPE - B

SIZE	VE-LOCK CODE	END CONNECTION	DIAMENSIONS				ADAPTOR HEX-A/F	COUPLER HEX-A/F	W.P.-BAR
			A	B	C	E			
1/8"	VE DC 1/8 "	BSP F X F	58.00	27.40	40.16	18.00	19.00	18.9	150
1/4"	VE DC 1/4"	BSP F X F	58.00	27.40	40.16	18.00	19.00	19.00	150
3/8"	VE DC 3/8 "	BSP F X F	65.20	35.12	44.70	19.50	22.22	22.22	150
1/2"	VE DC 1/2"	BSP F X F	71.10	41.50	50.10	24.00	28.00	28.00	150
3/4"	VE DC 3/4"	BSP F X F	77.30	44.60	56.60	26.00	32.00	32.00	75
1"	VE DC 1"	BSP F X F	85.00	55.00	60.00	30.00	41.00	41.00	75
1 1/4"	VE DC 1 1/4"	BSP F X F	95.00	70.00	65.00	30.00	51.00	59.00	20
1 1/2"	VE DC 1 1/2"	BSP F X F	95.00	75.00	65.00	30.00	55.00	59.00	20
2"	VE DC 2"	BSP F X F	113.00	85.00	78.00	35.00	66.00	69.00	20

ALL ABOVE DIMENSIONS ARE IN MM ONLY.

INBUILT CHECK VALVE IN SOCKET (COUPLER) + PLUG (ADAPTOR) BOTH SIDE

SEALING INSIDE - NBR RING

