

HOSE ADAPTOR - 60° CONE BOTH SIDE
ISO 1179-1 / ISO 228-1G

Properties

Design - As per BS 5500 standards worldwide
Material - Steel / Stainless Steel /Brass
Surface Protection for Steel - Zinc passivation or Chrome -VI Free (Trivalent Plated)
Material - Stainless steel -304 / 316 Grade
Surface finish Mat Buff Surface Finish

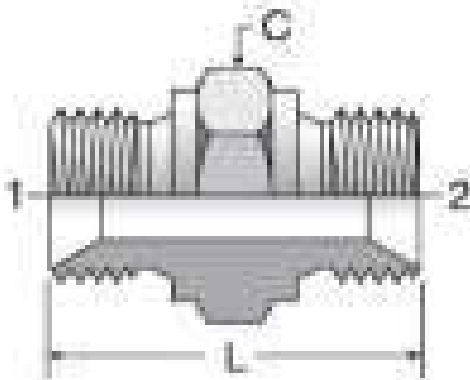

VE-LOCK ITEM CODE	END SIZE		C = HEX (mm)	L (mm)	W.P. =BAR HEAVY
	1 = BSP	2 = BSP			
VEHN 1/8 x 1/8	1/8	1/8	14	23.5	400
VEHN 1/4 x 1/8	1/4	1/8	19	28.0	400
VEHN 1/4 x 1/4	1/4	1/4	19	31.5	400
VEHN 3/8 x 1/4	3/8	1/4	22	33.2	400
VEHN 3/8 x 3/8	3/8	3/8	22	33.2	400
VEHN 1/2 x 1/4	1/2	1/4	27	36.7	400
VEHN 1/2 x 3/8	1/2	3/8	27	38.2	400
VEHN 1/2 x 1/2	1/2	1/2	27	40.7	400
VEHN 5/8 x 1/2	5/8	1/2	30	43.2	400
VEHN 5/8 x 5/8	5/8	5/8	30	45.2	400
VEHN 3/4 x 1/4	3/4	1/4	32	39.2	400
VEHN 3/4 x 3/8	3/4	3/8	32	40.7	400
VEHN 3/4 x 1/2	3/4	1/2	32	43.2	400
VEHN 3/4 x 5/8	3/4	5/8	32	45.2	400
VEHN 3/4 x 3/4	3/4	3/4	32	45.2	400
VEHN 1 x 1/2	1	1/2	41	46.9	400
VEHN 1 x 5/8	1	5/8	41	46.9	400
VEHN 1 x 3/4	1	3/4	41	48.9	400
VEHN 1 x 1	1	1	41	51.9	400
VEHN 1 1/4 x 3/4	1 1/4	3/4	50	57.4	400
VEHN 1 1/4 x 1	1 1/4	1	50	60.4	400
VEHN 1 1/4 x 1 1/4	1 1/4	1 1/4	50	61.4	400
VEHN 1 1/2 x 1	1 1/2	1	55	64.4	400
VEHN 1 1/2 x 1 1/4	1 1/2	1 1/2	55	65.4	400
VEHN 1 1/2 x 1 1/2	1 1/2	1 1/2	55	67.4	400
VEHN 2 x 1 1/2	2	1 1/2	70	72.9	400
VEHN 2 x 2	2	2	70	76.4	400

BULKHEAD HOSE ADAPTOR - 60° CONE BOTH SIDE
ISO 1179-1 / ISO 228-1G

Properties

Material - Steel / Stainless Steel /Brass
Surface Protection for Steel - Zinc passivation or Chrome -VI Free (Trivalent Plated)
Material - Stainless steel -304 / 316 Grade
Surface finish Mat Buff Surface Finish

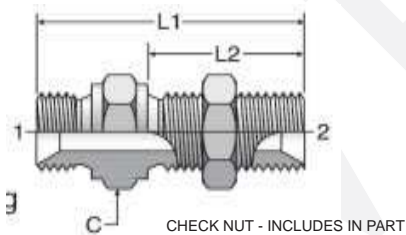

VE-LOCK ITEM CODE	END SIZE		C=HEX IN MM	L1 = MM	L2 = MM	W.P. =BAR HEAVY
	1	2				
VESV HN 1/4 x 1/4	1/4	1/4	19	46.8	28	400
VESV HN 3/8 x 3/8	3/8	3/8	22	52.5	32	400
VESV HN 1/2 x 1/2	1/2	1/2	27	59.0	35	400
VESV HN 5/8 x 5/8	5/8	5/8	30	61.5	35	400
VESV HN 3/4 x 3/4	3/4	3/4	32	64.5	38	400
VESV HN 1 x 1	1	1	41	71.2	41	400
VESV HN 1 1/4 x 1 1/4	1 1/4	1 1/4	50	82.7	44	400
VESV HN 1 1/2 x 1 1/2	1 1/2	1 1/2	55	90.7	48	400

MALE x FEMALE (SW.) ADAPTOR - 60° CONE BOTH SIDE
ISO 1179-1 / ISO 228-1G

Properties

Design - As per BS 5500 standards worldwide
Material - Steel / Stainless Steel /Brass
Surface Protection for Steel - Zinc passivation or Chrome -VI Free (Trivalent Plated)
Material - Stainless steel -304 / 316 Grade
Surface finish Mat Buff Surface Finish

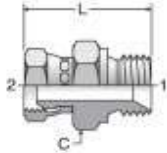

VE-LOCK ITEM CODE	END SIZE		C = HEX (mm)	L (mm)	W.P. =BAR HEAVY
	1 BSPP	2 BSPP			
VEMF 1/4 x 1/4	1/4	1/4	19	36.6	400
VEMF 1/4 x 3/8	1/4	3/8	22	38.5	400
VEMF 1/4 x 1/2	1/4	1/2	27	42.0	400
VEMF 3/8 x 1/4	3/8	1/4	22	38.3	400
VEMF 3/8 x 3/8	3/8	3/8	22	40.0	400
VEMF 3/8 x 1/2	3/8	1/2	27	43.6	400
VEMF 1/2 x 3/8	1/2	3/8	27	43.5	400
VEMF 1/2 x 1/2	1/2	1/2	27	46.1	400
VEMF 1/2 x 3/4	1/2	3/4	32	48.0	400
VEMF 3/4 x 1/2	3/4	1/2	32	48.6	400
VEMF 3/4 x 3/4	3/4	3/4	32	50.0	400
VEMF 3/4 x 1	3/4	1	41	54.3	400
VEMF 1 x 1	1	1	41	57.3	400

FEMALE x FEMALE (SW.) ADAPTOR - 60° CONE BOTH SIDE
ISO 1179-1 / ISO 228-1G

Properties

Design - As per BS 5500 standards worldwide
Material - Steel / Stainless Steel /Brass
Surface Protection for Steel - Zinc passivation or Chrome -VI Free (Trivalent Plated)
Material - Stainless steel -304 / 316 Grade
Surface finish Mat Buff Surface Finish

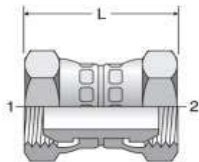

VE-LOCK ITEM CODE	END SIZE		W.P. =BAR HEAVY
	1= BSPP	2 =BSPP	
VEFF 1/4 x 1/4	1/4	1/4	37.0
VEFF 3/8 x 1/4	3/8	1/4	38.6
VEFF 3/8 x 3/8	3/8	3/8	40.5
VEFF 1/2 x 1/4	1/2	1/4	41.5
VEFF 1/2 x 3/8	1/2	3/8	42.9
VEFF 1/2 x 1/2	1/2	1/2	45.8
VEFF 5/8 x 5/8	5/8	5/8	47.5
VEFF 3/4 x 1/2	3/4	1/2	48.2
VEFF 3/4 x 3/4	3/4	3/4	49.5
VEFF 1 x 1	1	1	57.5
VEFF 1 1/4 x 1 1/4	1 1/4	1 1/4	66.0
VEFF 1 1/2 x 1 1/2	1 1/2	1 1/2	70.0

ELBOW - FEMALE (SW) BOTH SIDE
ISO 1179-1 / ISO 228-1G

Properties

Design - As per BS 5500 standards worldwide
Material - Steel / Stainless Steel /Brass
Surface Protection for Steel - Zinc passivation or Chrome -VI Free (Trivalent Plated)
Material - Stainless steel -304 / 316 Grade
Surface finish Mat Buff Surface Finish

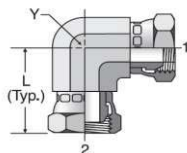

VE-LOCK ITEM CODE	END SIZE		L = MM	Y = MM	W.P. =BAR HEAVY
	1= BSPP	2 = BSPP			
VEWFSW 1/8 x 1/8	1/8	1/8	16.6	14	400
VEWFSW 1/4 x 1/4	1/4	1/4	30.5	19	400
VEWFSW 3/8 x 3/8	3/8	3/8	33.0	22	400
VEWFSW 1/2 x 1/2	1/2	1/2	38.8	27	400
VEWFSW 5/8 x 5/8	5/8	5/8	39.4	30	400
VEWFSW 3/4 x 3/4	3/4	3/4	42.3	32	400
VEWFSW 1 x 1	1	1	49.0	41	400
VEWFSW 1 1/4 x 1 1/4	1 1/4	1 1/4	58.2	46	400
VEWFSW 1 1/2 x 1 1/2	1 1/2	1 1/2	63.3	55	400

ADAPTOR - BSPP x NPTF

Properties

Design - As per BS 5500 standards worldwide
 Material - Steel / Stainless Steel /Brass
 Surface Protection for Steel - Zinc passivation or Chrome -VI Free (Trivalent Plated)
 Material - Stainless steel -304 / 316 Grade
 Surface finish Mat Buff Surface Finish

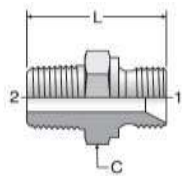

VE-LOCK ITEM CODE	END SIZE		C HEX (mm)	L = MM	W.P. =BAR HEAVY
	1= BSPP	2 = NPTF			
VEHN 1/8 BP x 1/8 NF	1/8	1/8	14	24.4	400
VEHN 1/8 BP x 1/4 NF	1/8	1/4	14	28.9	400
VEHN 1/4 BP x 1/8 NF	1/4	1/8	19	28.9	400
VEHN 1/4 BP x 1/4 NF	1/4	1/4	19	33.4	400
VEHN 1/4 BP x 3/8 NF	1/4	3/8	19	33.4	400
VEHN 3/8 BP x 1/4 NF	3/8	1/4	22	35.1	400
VEHN 3/8 BP x 3/8 NF	3/8	3/8	22	35.1	400
VEHN 3/8 BP x 1/2 NF	3/8	1/2	22	39.9	400
VEHN 1/2 BP x 3/8 NF	1/2	3/8	27	38.6	400
VEHN 1/2 BP x 1/2 NF	1/2	1/2	22	43.4	400
VEHN 5/8 BP x 1/2 NF	5/8	1/2	27	45.9	400
VEHN 5/8 BP x 3/4 NF	5/8	3/4	30	45.9	400
VEHN 3/4 BP x 3/4 NF	3/4	3/4	30	45.9	400
VEHN 3/4 BP x 1/2 NF	3/4	1/2	32	46.0	400
VEHN 3/4 BP x 1 NF	3/4	1	36	50.8	400
VEHN 1 BP x 1 NF	1	1	41	54.5	400
VEHN 1 BP x 3/4 NF	1	3/4	41	49.6	400
VEHN 1 1/4 BP x 1 1/4 NF	1 1/4	1 1/4	50	63.7	400
VEHN 1 1/2 BP x 1 1/2 NF	1 1/2	1 1/2	55	68.5	400

**REDUCING THREAD ADAPTOR - MALE x FEMALE
ISO 1179-1 / ISO 228-1G**

Properties

Design - As per BS 5500 standards worldwide
 Material - Steel / Stainless Steel /Brass
 Surface Protection for Steel - Zinc passivation or Chrome -VI Free (Trivalent Plated)
 Material - Stainless steel -304 / 316 Grade
 Surface finish Mat Buff Surface Finish

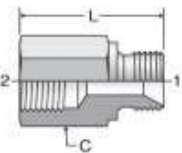

VE-LOCK ITEM CODE	END SIZE		C = HEX (mm)	L = MM	W.P. =BAR HEAVY
	1 = BSPP - MALE	2 = BSPP - FEMALE			
VERI 3/8 M x 1/4 F	3/8	1/4	22	37.1	400
VERI 3/8 M x 3/8 F	3/8	3/8	23	36.9	400
VERI 1/2 M x 1/4 F	1/2	1/4	27	38.0	400
VERI 1/2 M x 3/8 F	1/2	3/8	30	45.3	400
VERI 3/4 M x 1/4 F	3/4	1/4	32	40.0	400
VERI 3/4 M x 3/8 F	3/4	3/8	32	41.6	400
VERI 3/4 M x 1/2 F	3/4	1/2	32	47.3	400
VERI 1 M x 1/4 F	1	1/4	41	43.0	400
VERI 1 M x 3/8 F	1	3/8	41	44.6	400
VERI 1 M x 1/2 F	1	1/2	41	50.3	400
VERI 1 M x 3/4 F	1	3/4	41	52.2	400

**HEX PLUG - BSPP THREADS
ISO 1179-1 / ISO 228-1G**

Properties

Design - As per BS 5500 standards worldwide
 Material - Steel / Stainless Steel /Brass
 Surface Protection for Steel - Zinc passivation or Chrome -VI Free (Trivalent Plated)
 Material - Stainless steel -304 / 316 Grade
 Surface finish Mat Buff Surface Finish

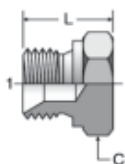

VE-LOCK ITEM CODE	END SIZE	C = HEX (mm)	L = MM	W.P. =BAR HEAVY
	1 =BSPP			
VEHP 1/8	1/8	14	14.3	400
VEHP 1/4	1/4	19	18.8	400
VEHP 3/8	3/8	22	20.5	400
VEHP 1/2	1/2	27	24.0	400
VEHP 5/8	5/8	30	24.0	400
VEHP 3/4	3/4	32	26.5	400
VEHP 1	1	41	30.2	400
VEHP 1 1/4	1 1/4	50	38.7	400
VEHP 1 1/2	1 1/2	55	42.7	400
VEHP 2	2	70	48.2	400

**CAP FEMALE SWIEVEL
ISO 1179-1 / ISO 228-1G**

Properties

Design - As per BS 5500 standards worldwide
 Material - Steel / Stainless Steel /Brass
 Surface Protection for Steel - Zinc passivation
 or Chrome -VI Free (Trivalent Plated)
 Material - Stainless steel -304 / 316 Grade
 Surface finish Mat Buff Surface Finish

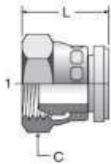

VE-LOCK ITEM CODE	END SIZE	C = HEX (mm)	L = MM	W.P. =BAR HEAVY
	1 =BSPP			
VECAP SW 1/8	1/8	14	16	400
VECAP SW 1/4	1/4	19	20.6	400
VECAP SW 3/8	3/8	22	22.3	400
VECAP SW 1/2	1/2	27	22.7	400
VECAP SW 5/8	5/8	30	26.6	400
VECAP SW 3/4	3/4	32	28.0	400
VECAP SW 1	1	41	31.6	400
VECAP SW 1 1/4	1 1/4	50	35.9	400
VECAP SW 1 1/2	1 1/2	60	37.9	400

**UNION ELBOW - BSPP
ISO 1179-1 / ISO 228-1G**

Properties

Design - As per BS 5500 standards worldwide
 Material - Steel / Stainless Steel /Brass
 Surface Protection for Steel - Zinc passivation
 or Chrome -VI Free (Trivalent Plated)
 Material - Stainless steel -304 / 316 Grade
 Surface finish Mat Buff Surface Finish

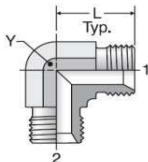

VE-LOCK ITEM CODE	END SIZE		L = MM	Y = MM	W.P. =BAR HEAVY
	1 = BSPP	2 = BSPP			
VEW 1/8 x 1/8	1/8	1/8	16.6	14	400
VEW 1/4 x 1/4	1/4	1/4	27.8	19	400
VEW 3/8 x 3/8	3/8	3/8	31.7	22	400
VEW 1/2 x 1/2	1/2	1/2	37.0	27	400
VEW 5/8 x 5/8	5/8	5/8	39.0	30	400
VEW 3/4 x 3/4	3/4	3/4	41.6	32	400
VEW 1 x 1	1	1	49.7	41	400
VEW 1 1/4 x 1 1/4	1 1/4	1 1/4	54.4	46	400
VEW 1 1/2 x 1 1/2	1 1/2	1 1/2	53.7	55	400

**ELBOW - MALE x FEMALE (SW)
ISO 1179-1 / ISO 228-1G**

Properties

Design - As per BS 5500 standards worldwide
 Material - Steel / Stainless Steel /Brass
 Surface Protection for Steel - Zinc passivation
 or Chrome -VI Free (Trivalent Plated)
 Material - Stainless steel -304 / 316 Grade
 Surface finish Mat Buff Surface Finish

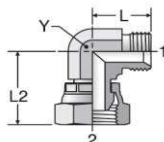

VE-LOCK ITEM CODE	END SIZE		L = MM	L2 = MM	Y = MM	W.P. =BAR HEAVY
	1 = BSPP	2 = BSPP				
VEWMFSW 1/8 x 1/8	1/8	1/8	16.6	22.0	14	400
VEWMFSW 1/4 x 1/4	1/4	1/4	27.8	31.2	19	400
VEWMFSW 3/8 x 3/8	3/8	3/8	31.7	36.2	22	400
VEWMFSW 1/2 x 1/2	1/2	1/2	37.0	41.0	27	400
VEWMFSW 5/8 x 5/8	5/8	5/8	39.0	41.6	30	400
VEWMFSW 3/4 x 3/4	3/4	3/4	41.6	45.3	32	400
VEWMFSW 1 x 1	1	1	49.7	53.9	41	400
VEWMFSW 1 1/4 x 1	1 1/4	1 1/4	54.4	60.0	46	400
VEWMFSW 1 1/2 x 1	1 1/2	1 1/2	53.7	63.3	55	400

**BRANCH TEE - SWIVEL NUT TYPE
ISO 1179-1 / ISO 228-1G**

Properties

Design - As per BS 5500 standards worldwide
Material - Steel / Stainless Steel /Brass
Surface Protection for Steel - Zinc passivation
or Chrome -VI Free (Trivalent Plated)

Material - Stainless steel -304 / 316 Grade
Surface finish Mat Buff Surface Finish

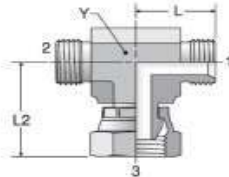

VE-LOCK ITEM CODE	END SIZE			L = MM	L2 = MM	Y = MM	W.P. =BAR HEAVY
	1 =BSPP	1 =BSPP	1 =BSPP				
							S
VE2S6MK4	1/8	1/8	1/8	16.6	22.0	11	5.1
VE4S6MK4	1/4	1/4	1/4	27.8	31.2	19	5.1
VE6S6MK4	3/8	3/8	3/8	31.7	36.2	27	5.1
VE8S6MK4	1/2	1/2	1/2	37.0	41.0	27	2.9
VE10S6MK4	5/8	5/8	5/8	39.0	41.6	27	2.9
VE12S6MK4	3/4	3/4	3/4	41.6	45.3	33	2.9
VE16S6MK4	1	1	1	49.7	53.9	41	1.8
VE20S6MK4	1 1/4	1 1/4	1 1/4	54.4	60.0	48	1.5

**TEE - FEMALE (SW) ALL SIDES
ISO 1179-1 / ISO 228-1G**

Properties

Design - As per BS 5500 standards worldwide
Material - Steel / Stainless Steel /Brass
Surface Protection for Steel - Zinc passivation
or Chrome -VI Free (Trivalent Plated)

Material - Stainless steel -304 / 316 Grade
Surface finish Mat Buff Surface Finish

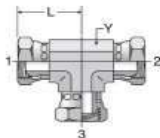

VE-LOCK ITEM CODE	END SIZE			L = MM	Y = MM	W.P. =BAR HEAVY
	1 =BSPP	1 =BSPP	1 =BSPP			
VE4J6MK4	1/4	1/4	1/4	30.5	14	400
VE6J6MK4	3/8	3/8	3/8	33.0	19	400
VE8J6MK4	1/2	1/2	1/2	38.8	22	400
VE10J6MK4	5/8	5/8	5/8	39.4	22	400
VE12J6MK4	3/4	3/4	3/4	42.3	27	400
VE16J6MK4	1	1	1	49.0	33	400
VE20J6MK4	1 1/4	1 1/4	1 1/4	58.2	41	400

**RUN TEE - SWIVEL NUT TYPE
ISO 1179-1 / ISO 228-1G**

Properties

Design - As per BS 5500 standards worldwide
Material - Steel / Stainless Steel /Brass
Surface Protection for Steel - Zinc passivation
or Chrome -VI Free (Trivalent Plated)

Material - Stainless steel -304 / 316 Grade
Surface finish Mat Buff Surface Finish

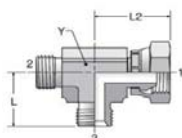

VE-LOCK ITEM CODE	END SIZE		L = MM	L2 = MM	Y = MM	W.P. =BAR HEAVY
	1 =BSPP	1 =BSPP				
						S
VE2R6MK4	1/8	1/8	1/8	16.6	22.0	5.1
VE4R6MK4	1/4	1/4	1/4	27.8	31.2	5.1
VE6R6MK4	3/8	3/8	3/8	31.7	36.2	5.1
VE8R6MK4	1/2	1/2	1/2	37.0	41.0	5.1
VE10R6MK4	5/8	5/8	5/8	39.0	41.6	5.1
VE12R6MK4	3/4	3/4	3/4	41.6	45.3	5.1
VE16R6MK4	1	1	1	49.7	53.9	5.1
VE20R6MK4	1 1/4	1 1/4	1 1/4	54.4	60.0	5.1

**UNION TEE - MALE BSPP THREADS ALL SIDE
ISO 1179-1 / ISO 228-1G**

Properties

Design - As per BS 5500 standards worldwide
 Material - Steel / Stainless Steel /Brass
 Surface Protection for Steel - Zinc passivation
 or Chrome -VI Free (Trivalent Plated)
 Material - Stainless steel -304 / 316 Grade
 Surface finish Mat Buff Surface Finish

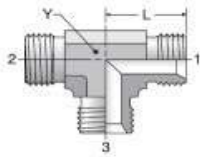

VE-LOCK ITEM CODE	END SIZE			L = MM (mm)	Y = MM (mm)	W.P. =BAR HEAVY
	1 =BSPP	1 =BSPP	1 =BSPP			
						S
VE2JMK4	1/8	1/8	1/8	16.6	11	
VE4JMK4	1/4	1/4	1/4	27.8	19	5.1
VE6JMK4	3/8	3/8	3/8	31.7	22	5.1
VE8JMK4	1/2	1/2	1/2	37.0	27	2.9
VE10JMK4	5/8	5/8	5/8	39.0	27	2.9
VE12JMK4	3/4	3/4	3/4	41.9	33	2.9
VE16JMK4	1	1	1	49.7	41	1.7
VE20JMK4	1 1/4	1 1/4	1 1/4	54.4	48	1.5
VE24JMK4	1 1/2	1 1/2	1 1/2	53.7	48	1.5



BONDED WASHER

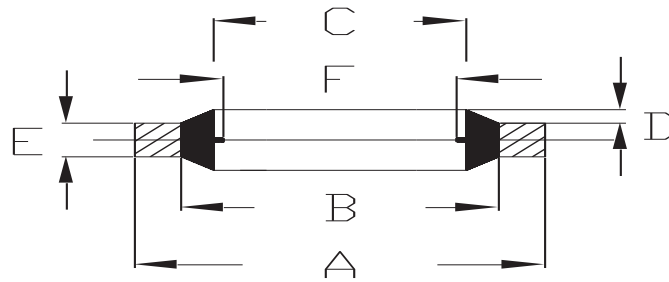

SIZE BSP	PART NO	A	B	C	D	E	F	Kg/100
1/8	VE DW1/8	15.88	11.84	10.37	0.25/0.51	2.03	8.56	0.15
1/4	BW04	20.57	15.21	13.74	0.25/0.51	2.03	11.45	0.25
3/8	BW06	23.8	18.75	17.28	0.25/0.51	2.03	14.96	0.29
1/2	BW08	28.58	23.01	21.54	0.25/0.51	2.49	18.64	0.46
3/4	BW12	34.93	28.53	27.05	0.25/0.51	2.49	24.13	0.62
1	BW16	42.8	36.88	33.89	0.25/0.51	3.38	30.3	0.79
1	BW20	52.38	45.93	42.93	0.25/0.51	3.38	38.96	1.04
1	BW24	58.6	51.39	48.44	0.25/0.51	3.38	44.86	1.3
2	BW32	73.03	63.63	60.58	0.25/0.51	3.38	56.67	2.14

