

PIPE CLAMP - STANDARD SERIES - DOUBLE VERTICAL TYPE

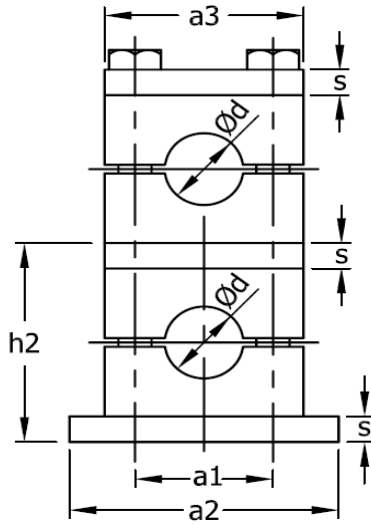

ONE SET = ONE TOP PLATE + ONE BOTTOM PLATE + 2 HEX BOLTS + TWO PAIRS OF PP JAWS + 2 STACKING BOLTS + 1 LOCKING PLATE

DIN GROUP	OUR PART CODE	PIPE OD Dia - d	a2	a3	a1	s	h2	HEX BOLT SIZE
	Ve-Lock	IN MM	IN MM	IN MM	IN MM	IN MM	IN MM	SIZE x LENGTH
1	PCL 4 MM x 2	4	43	37	20	3	33	M6 X 30 MM
	PCL 6 MM x 2	6						
	PCL 6.4 MM x 2	6.4						
	PCL 8 MM x 2	8						
	PCL 9.5 MM x 2	9.5						
	PCL 10 MM x 2	10						
	PCL 12 MM x 2	12						
2	PCL 12.7 MM x 2	12.7	48	42	26	3	39	M6 X 35 MM
	PCL 13.5 MM x 2	13.5						
	PCL 14 MM x 2	14						
	PCL 15 MM x 2	15						
	PCL 16 MM x 2	16						
	PCL 17.2 MM x 2	17.2						
	PCL 18 MM x 2	18						

3	PCL 19 MM x 2	19	56	50	33	3	42	M6 X 40 MM
	PCL 20 MM x 2	20						
	PCL 21.3 MM x 2	21.3						
	PCL 22 MM x 2	22						
	PCL 25 MM x 2	25						
4	PCL 26.9 MM x 2	26.9	65	59	40	3	48	M6 X 45 MM
	PCL 28 MM x 2	28						
	PCL 30 MM x 2	30						
5	PCL 32 MM x 2	32	77	71	52	3	64	M6 X 60 MM
	PCL 33.7 MM x 2	33.7						
	PCL 35 MM x 2	35						
	PCL 38 MM x 2	38						
	PCL 40 MM x 2	40						
	PCL 42 MM x 2	42						
6	PCL 44.5 MM x 2	44.5	92	86	66	3	72	M6 X 70 MM
	PCL 48.3 MM x 2	48.3						
	PCL 50.8 MM x 2	50.8						
7	PCL 57.2 MM x 2	57.2	122	118	94	5	103	M6 x 100 MM
	PCL 60.3 MM x 2	60.3						
	PCL 63.5 MM x 2	63.5						
	PCL 70 MM x 2	70						
	PCL 73 MM x 2	73						
	PCL 76.1 MM x 2	76.1						